

Installation Instructions

For

WiFi-Predator

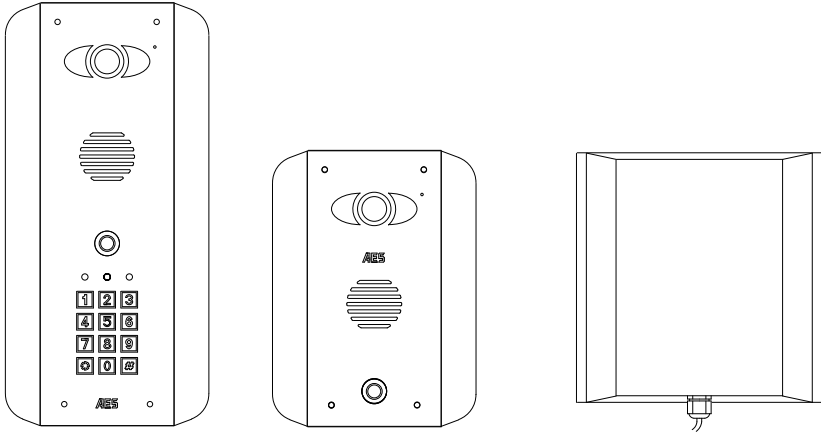

Index

Section	Pages
Android Configuration	3-6
iphone Configuration	7-11
Range and range testing	12-13
Installation	14
Power Supply	14
Wiring	15
Relay Output	16
Keypad Overview	16
Basic Keypad Programming	17
Full Keypad Programming	17
Using the Keypad	18
Adding Additional Smart Phones & Devices	19-20
Using the Intercom on Android	21
Using the Intercom on iphone	22
Other options	23
Fault Finding	24
Revision changes	25

Android Configuration

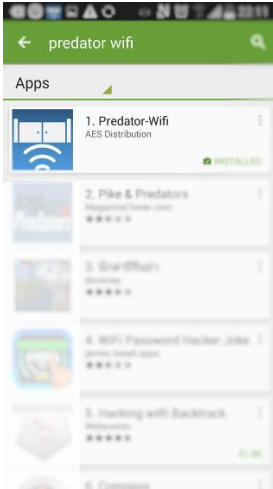

Step 1

Using one of the homeowners' Android phones, search for "**Predator WiFi**" on the Google Play store. Look for the icon shown. Then download and install to the users phone.

Step 2

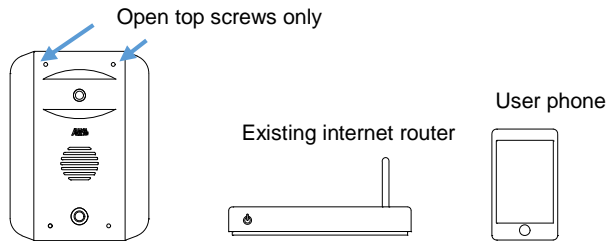

Locate the intercom on a bench or table beside the home router, along with the user phone. Connect the antenna & power supply provided to the intercom, red to +24v dc and black to 0v dc, and power on.



Step 3

Wait a full 60 seconds for the intercom to fully boot up.

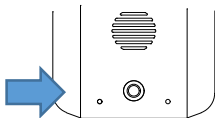

Step 4

Press and hold the call button for more than **3 seconds**. A loud tone will be heard. The intercom will now be in configuration mode for 5 minutes.



Step 5

Enter settings on the phone, select WiFi and scan for networks. The phone should detect the intercom. The network name will be BELL-XXXXX)



Step 6

Enter the following password... 123456789.



Step 7

Now open the WiFi-Predator App on the phone and select as shown to add intercom.



Step 8

On the next screen, select search as shown.



Step 9

The phone should then find the device. Select it as shown.



Step 10

On the next screen the intercom should be showing online status. Select the settings button.



Step 11

Enter WiFi settings as shown.



Step 12

Select option to manage wifi networks and the intercom will now scan networks in the area.



Step 13

Select the network which the home owner is normally using.

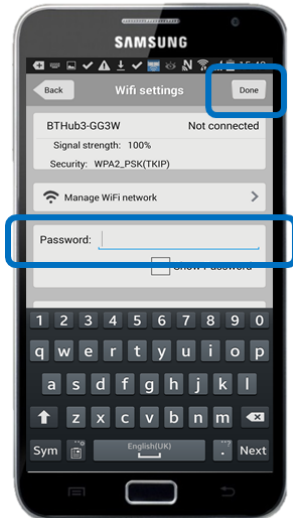

Step 14

Enter the home owner's WiFi password and press DONE. The intercom should now re-boot and the phone should then re-connect to the normal wifi network.



2 mins...

Step 15

Wait 2 minutes for the intercom to come back online, and then open the app. The intercom should be showing status online.



Step 16

You may now press the call button and check that the intercom calls the phone successfully.

You are now ready to range test the intercom in the location which it will be used!

I-phone Configuration

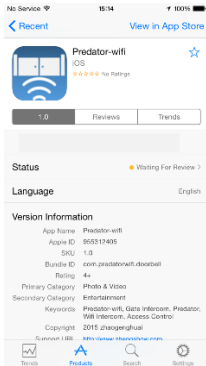

Step 1

Using one of the homeowners' iPhones, search for "**Predator-WiFi**" app on the Apple Store. Look for the icon shown. Then download and install to the users phone.

Step 2

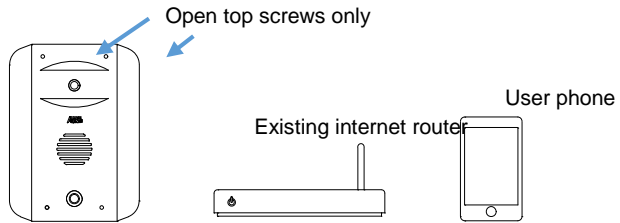

Locate the intercom on a bench or table beside the home router, along with the user phone. Connect the antenna & power supply provided to the intercom, red to +24v dc and black to 0v dc, and power on.



Step 3

Wait a full 60 seconds for the intercom to fully boot up.

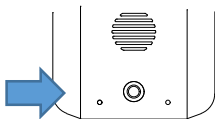

Step 4

Press and hold the call button for more than **3 seconds**. The intercom will sound a long tone, and now be in configuration mode for 5 minutes.

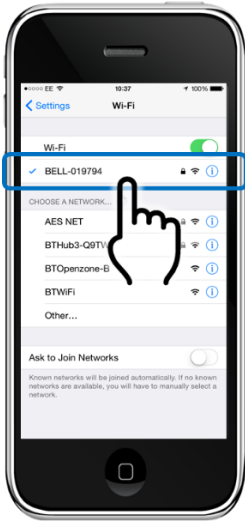

Step 5

Enter settings on the phone, select WiFi and scan for networks. The phone should detect the intercom. The network name will be BELL-XXXXX)

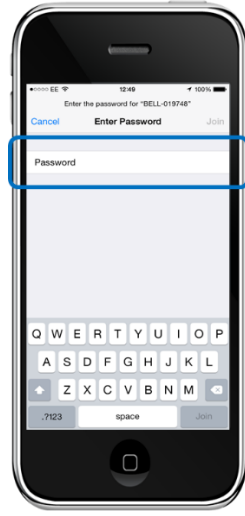

Step 6

Enter the following password... 123456789. Now the iPhone is directly connected to the intercom.



Step 7

Now open the WiFi-Predator App on the phone and select as shown to add intercom.

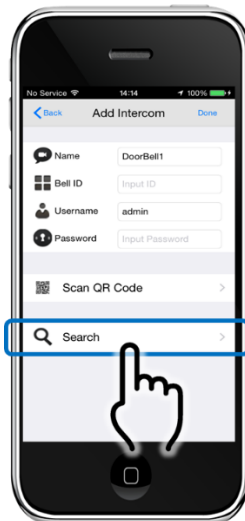

Step 8

Press search. The phone should now detect the intercom.



Step 9

The intercom should now have been detected. Select as shown.

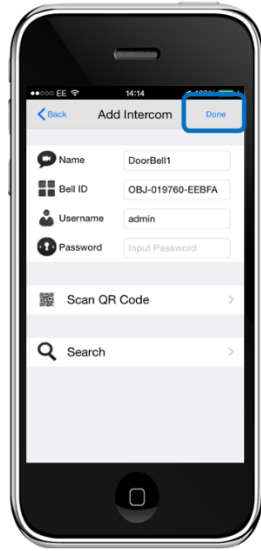

Step 10

Now the app should show the bell ID, default username & password details. Press DONE as shown.



Step 11

Enter Settings as shown.

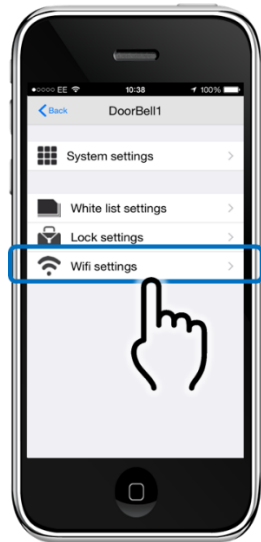

Step 12

Select option to manage wifi networks and the intercom will now scan networks in the area.

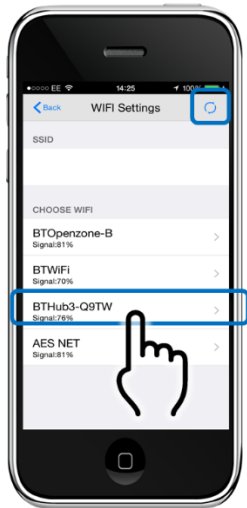

Step 13

Select the network which the home owner is normally using. Note the scan button at top if the iphone does not automatically scan for networks.

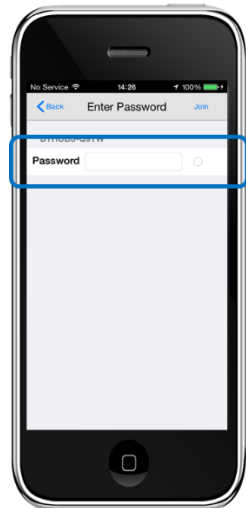

Step 14

Enter the home owner's WiFi password and press JOIN. The intercom should now re-boot.



2 mins...

Step 15

Wait 2 minutes for the intercom to come back online, and then open the app. The intercom should be showing status online.

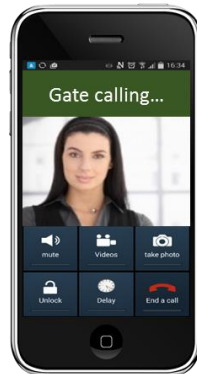

Step 16

You may now press the call button and check that the intercom calls the phone successfully. Note: It may take several minutes for the operation to fully stabilise.

Note: Because of restrictions by Apple, your iphone will receive a notification message first. If your screen is locked, you must swipe the notification banner, then unlock the screen before the intercom app can begin calling the phone in full as shown...



1. Swipe & unlock.



2. App screen appears.

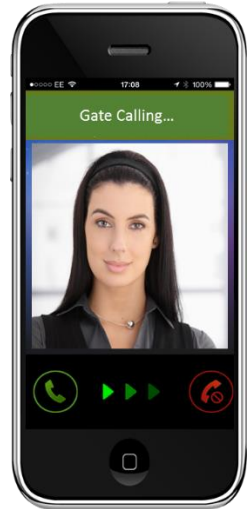

3. Ringing screen appears

Note: If the phone does not receive a notification message when the app is running in background mode or when the screen is locked, please follow the steps below and try again...

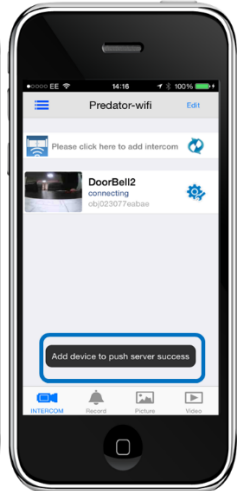
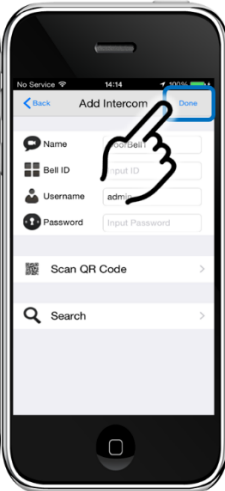
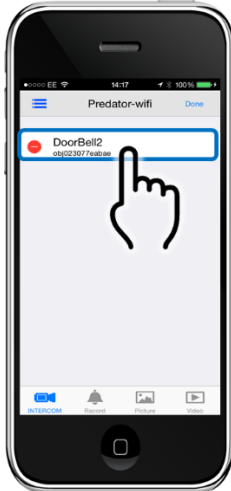

Please take note at the end of the process, the phone should show the success message as shown. If it shows a fail message, please repeat the process.

Range Test

Before fully installing this product, it is strongly recommended to **temporarily** power the intercom at the gate and position the antenna to check that it is within range of the WiFi router. **The manufacturer will not give a full refund for a product which is not returned in brand new condition.**

Once the antenna is in position and the unit has been powered up for more than 2 minutes, use the users phone inside the house to check for range as follows..



Check that the network which it is connected to is showing at least 20% strength. If it is not connecting, or is lower than 20%, then corrective action must be taken at this stage. Suggestions are as follows..

1. Ensure antenna is mounted as high as possible on the pillar or post.

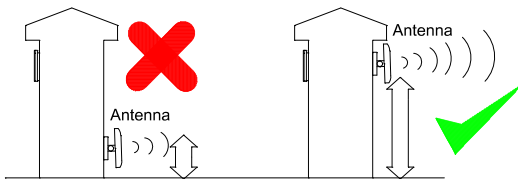

2. Change antenna angle slightly then re-scan the WiFi strength as shown above to check for improvements in strength. If signal improves, then continue to make small adjustments to the antenna angle and pitch to maximise strength.

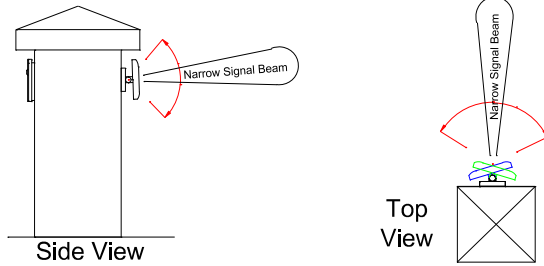

TIP: Antenna beam width is approximately 40 degrees. For short range door intercoms, ask your distributor or dealer for an omni-pole type antenna with 360 degree beam angle.

3. For longer range applications, check if the router is, or can be located at the front of the building, preferably near a window or glass, as this will greatly extend range as shown.

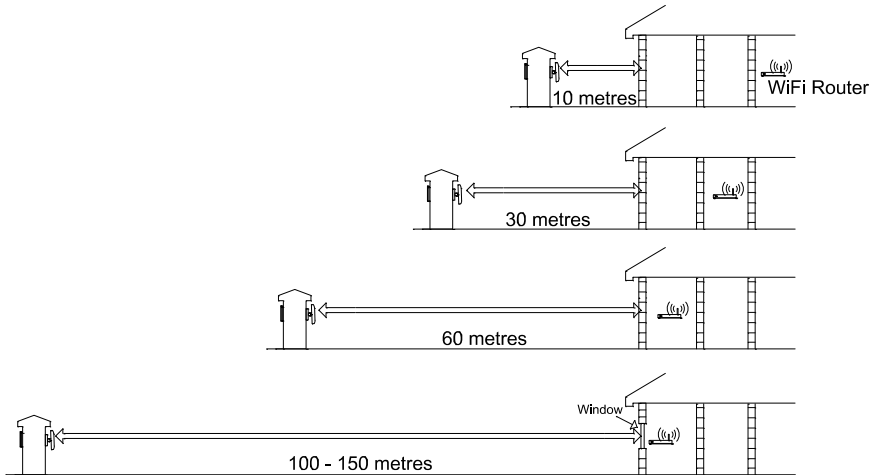

4. If it is not possible to have the WiFi router at the front of the building, then consider installing a standard “on the market” WiFi repeater or ranger extender. These can be purchased as a plug in device and are sold in DIY and consumer electronics stores.

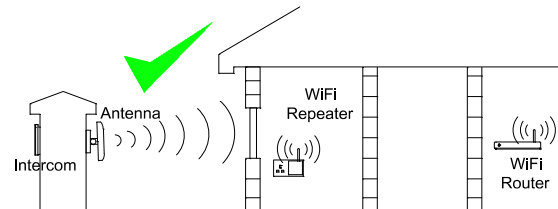

5. For even greater range, you can alternatively connect home plug power line adaptors to the LAN socket on the intercom and on the home router.

Installation

Assuming satisfactory operation at full range, you are ready to fully install the product.

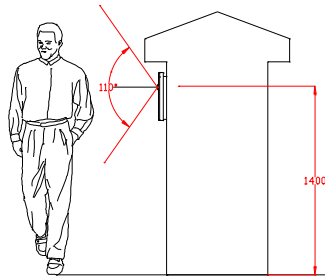

Mount the intercom at the desired height for pedestrian or car users. The camera angle is wide at 110 degrees to cover most scenarios.

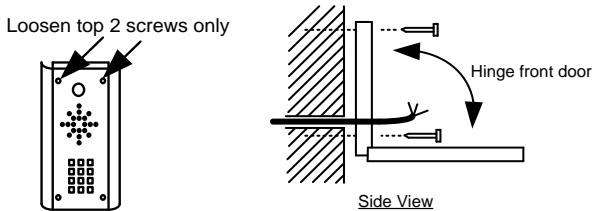

Tip: Do not drill holes in the wall with the intercom in position, otherwise dust may get around the camera window and impair the camera view.

Power supply

If possible, locate the power supply as close as possible to the intercom.

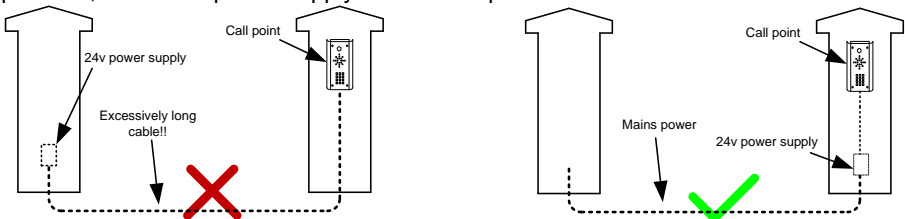

TIP: Most technical calls received are due to installers using CAT5 or alarm cable to power the unit. Neither are rated to carry enough power (1.5 amp peak). Please use following cable sizes...

Up to 2 metres (6 feet) – Minimum 0.5mm² (20 gauge)

Up to 4 metres (12 feet) – Minimum 1mm² (16 gauge)

Up to 8 metres (24 feet) – Minimum 1.5mm² (14 gauge)



WARNING

Warranty VOID if power cable requirements are not followed!

Wiring

Connect power as shown. Please use only the power adaptor provided.

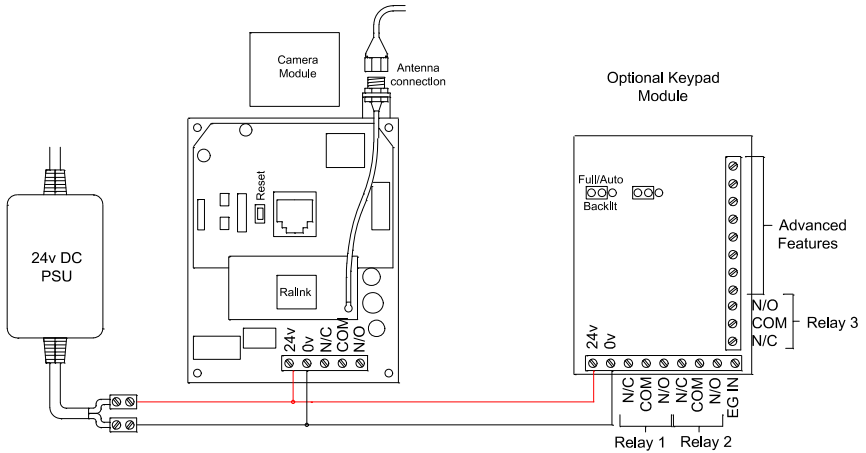

Depending on your requirements, the intercom and keypad have both normally closed and normally open output contacts for connection to existing electric locks or gate automation controllers.

Connection to Automatic Gates

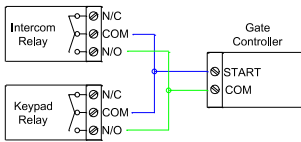

Connection to Magnetic Lock

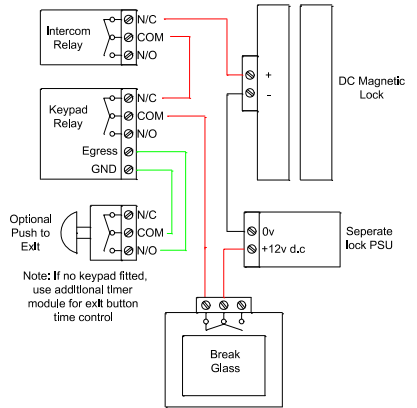

Connection to Door Strike Lock

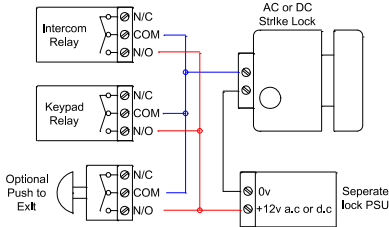

Note: The manufacturer can only support the use, operation and functionality of the intercom and keypad themselves. Professional wiring to door release or automatic gate systems is the responsibility of the installer. Please consult a security integrator for further support.

Relay output

The app has an option to switch the relay output from normally open to normally closed. This is not normally needed because the relay output terminals already have hard connections for N/O and N/C contacts as standard.

The **relay time** may need changed to suit **lock** applications. It is adjustable from 1-9 seconds as shown..



Keypad Overview

This keypad has 3 outputs. The diagram below shows the LED indicators which indicate programming and relay status information.

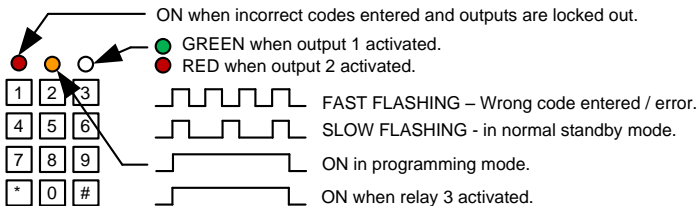

TIP: After power up, as a security precaution, the keypad cannot be programmed for 60 seconds. Once this time elapses, you may begin.

TIP: Flashing amber LED is normal standby mode!

Basic Keypad Programming

For most installs, it is sufficient to simply enter a single user code as follows..

Quick start guide

1) Enter programming mode (amber LED should be ON)

0 0 0 0 * *

2) Enter a new user code...

1 0 2 0 0 0 ? ? ? ? #

3) Exit programming mode

* *

4) Enter the new user code to check the relay clicks.

Tip: The engineer code must be the same length as user codes. So if using a 6 digit engineer code, then user codes must also be 6 digits long etc.

Full Keypad Programming

Enter programming mode..

0 0 0 0 * *

The unit is now in programming mode. Amber LED on the keypad should remain permanently on. 0000 is the default programming passcode.

Exit programming mode..

* *

The unit should exit programming mode and the amber LED should start flashing again.

Enter a new ENGINEERS code...

Go into programming mode firstly then enter the following sequence...

0 1 ? ? ? ? #

Location 4-8 digit code Validate

Replace ???? with your new ENGINEERS code.

Enter or delete new user codes

There are 3 groups of user codes. Group 10 for relay 1, group 20 for relay 2, and group 30 for relay 3. The programming sequence is shown below...

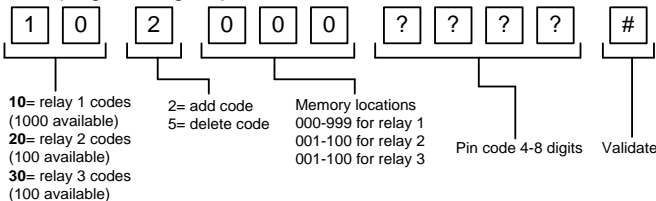

Example: Add user 31 to have access code 5555 operating relay 2....

2 0 2 0 3 1 5 5 5 5 #

Group 2 Add code Location 31 Pin code 5555 Validate

Programming relay output times and modes...

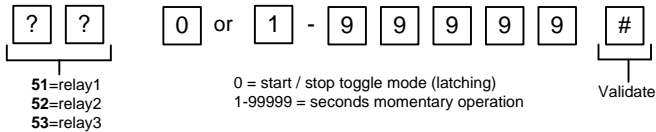

Delete a user code even if you don't know the code...

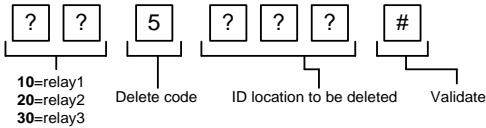

Delete an entire group of codes

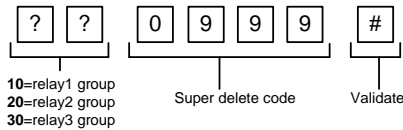

Programming super user codes...

A super user code can activate any of the 3 relays

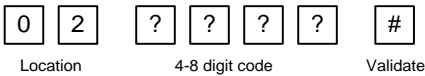

Restoring defaults

When in programming mode, you can enter the following sequence...

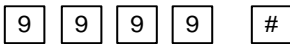

When the master code is forgotten....

- 1) Wire a push button (or replicate with wire link) across the Egress terminal and (-)GND.
- 2) Switch off power for 1 minute.
- 3) Switch ON power.
- 4) During the first 60 seconds, press the EG button once to enable the function.
- 5) Enter the following code..

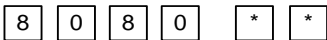

The keypad should now be in programming mode, ready to accept new data.

Using the keypad

Using the standard codes...

Once you have exited out of programming mode, simply enter the user code.

Using super user codes

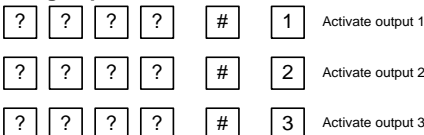

Adding Additional Smartphones or Devices



Step 1

Go to settings on the app screen for the existing phone or device.



Step 2

Select add user settings.



Step 3

Select ADD to create a new user.

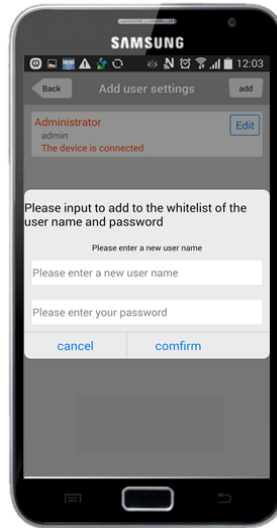

Step 4

Create a new username and password for that user. **Note that each user or device needs a totally unique username.**



Step 5

On the **new phone**, open the app and press to **ADD Intercom**.

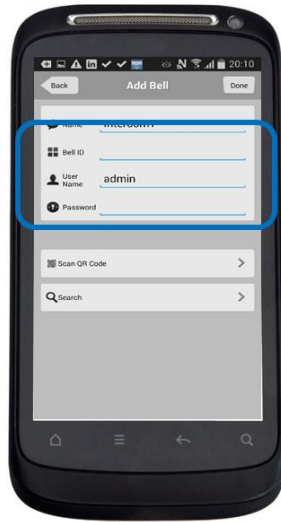

Step 6

Enter the **BELL ID** (Copy from the existing connected device) or press search to find the device, enter new user name and passcode, and press **DONE**. The new device should now be added.

Using the Intercom on Android

When the intercom calls your phone, answer the call and note the options shown..



Other options...

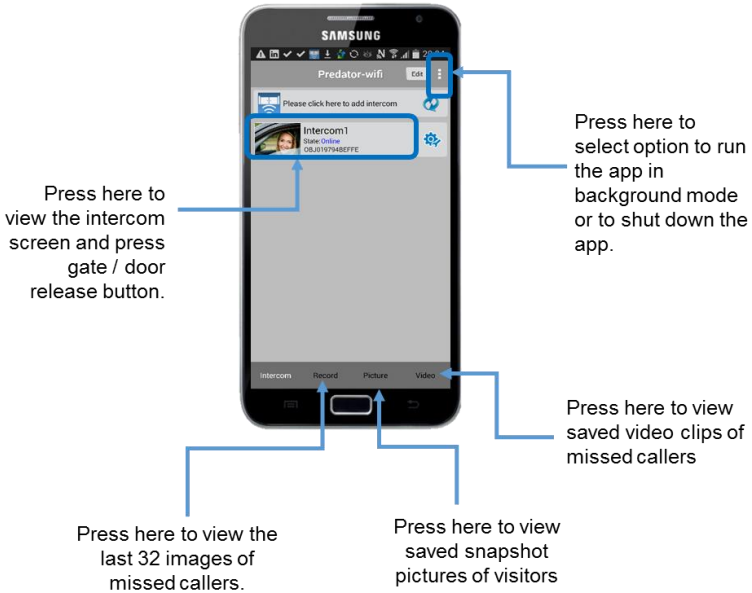

Using the Intercom on iPhone

When the intercom calls your phone, answer the call and note the options shown.

Note: Because of restrictions by Apple, your iPhone will receive a notification message first. If your screen is locked, you must swipe the notification banner, then unlock the screen before the intercom app can begin calling the phone in full.



1. Swipe the message

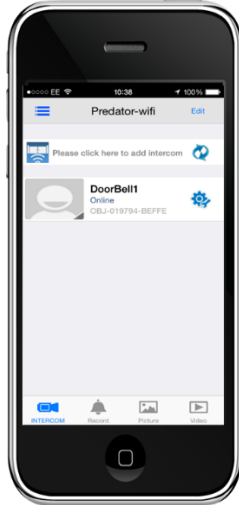

2. Screen shown after unlock

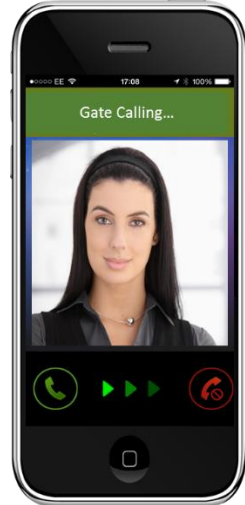

3. Swipe to answer.

Once the call is answered, the following screen is shown...



Other options...

You may view live video from the intercom at any time as shown below.



Fault Finding

The 3 most common cause of failures on the wifi intercom are as follows...

1. Unstable wifi network or excessive network traffic.
2. Range too long causing wifi drop out intermittently.
3. Excessively long power cable run from the 24v dc adaptor to the intercom causing poor range, no video, long connection times, or unstable operation.
4. Using 24v ac to power the device rather than the 24v dc adaptor supplied. This can damage the intercom.

Q: Unit works in the house, but will not work at the gate.

A: This will either be that the wifi range does not reach the gate, or the power cable is too long and thin. Please address as per the install manual recommendations.

Q: Unit was working on first phone, but not on second phone.

A: Check that both phones have different usernames and passwords.

Q: Unit works on local WiFi network, but not when my phone is on 3G or 4G.

A: This may be due to slow broadband speeds at your router. Remember, a good download speed is not useful, as the intercom uploads video to the internet, not downloads from the internet. Consult your broadband provider, re-start your router.

A: This may also be due to firewall settings on some routers or networks. Consult your IT manager or provider.

Q: Unit goes offline for several minutes when I switch from wifi to 3G/4G.

A: This is normal. Your phone needs time to send its new IP location to the servers, which is relayed to the intercom.

Q: Volume too low on my phone (cannot hear person at the gate).

A: The volume on your phone is restricted by the size of the loud speaker on the phone. Try increasing phone volume to maximum. Also check that the call point location is at a good height for someone to speak directly into the microphone.

Q: The intercom was working, but has stopped working.

A: Check if it is working on another phone. If yes, then restart and re-open the app on the phone in question.

A: If it is not working on any phones, re-start the router or hub, wait 5 minutes and try again.

A: Check the intercom still has power (illumination should still be on).

A: Check that the antenna at the gate is not overgrown with bushes or shrubs.

Before calling technical support for any connectivity issues, try the following...

Power off and on the intercom, the hub, and the phone being used. After 5 minutes, try using the intercom again.

Revision Changes

Hardware	Firmware version	IOS version	Android Version
V1.1 – Improved speaker amplifier for louder volume.	V3.24.4.12 – Relay default set to N/O.	V1.0 – Custom ring tones added, relay defaulted to 1 second.	V3.0 – Customised ring tones added, relay defaulted to 1 second.
			V3.2 – App updated for android OS version 5.2
			V3.3 – Update for faster switching between wifi and 3G/4G. Also lower battery consumption.

